



Arroyo Vista Elementary School

Case Study



The Right Space,
At The Right Time,
For The Right Price™



The Modular Advantage:

- Reduced project time
- Less site disruption
- Rivalling site built
quality and appearance

Project Team Members:

Modtech®
Ruhnau Ruhnau Clark, Architect

Project Overview

Designed to fit in seamlessly with the existing buildings, the Arroyo Vista Charter School kindergarten building is attractive as well as functional. The building is 72' x 40' and contains two kindergarten classrooms. The project includes features such as concrete floor poured over metal pan, 2:12 slope roof and traditional 3 coat stucco exterior matching the other buildings. The all electric split heat pump HVAC systems are rated at 12 SEER and the cooling coils are located in the ceiling cavity to conserve floor space. The required restrooms are shared between the classrooms to maximize space. Each classroom features a "wet" area outside of the teaching space which includes a kindergarten size sink and linoleum floor for easier cleaning.

Groundbreaking for the permanent concrete foundation occurred in October 2005 and the building was finished within 4 months. The project was completed within the expected time and the end result was another satisfied Modtech customer.

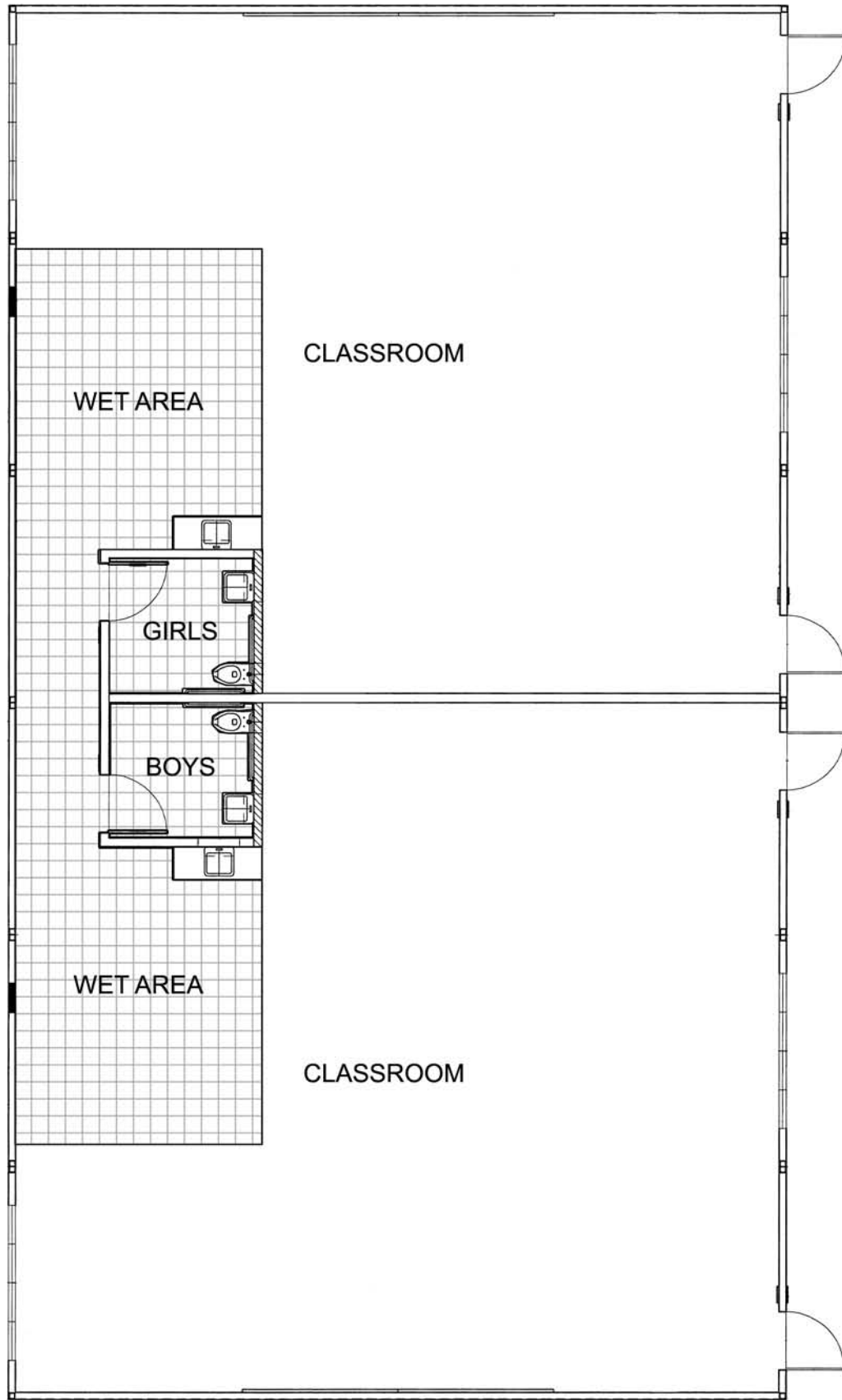

West Region

Southwest Region

South Central Region

Southeast Region

Toll free 1-888-929-0998 · www.modtech.com